

# Kinghelm®

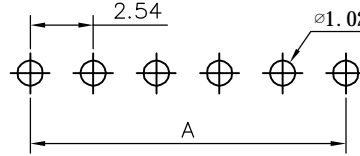

RECOMMEND P.C.B LAYOUT  
PCB TOLERANCE: ±0.05 (TOP VIEW)

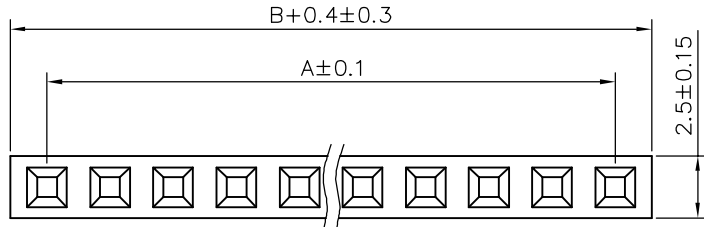
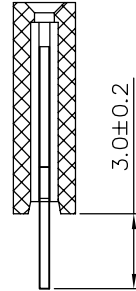
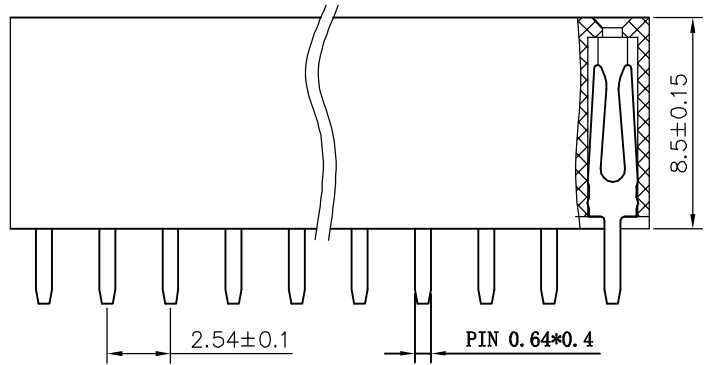

## SPECIFICATIONS

Current Rating: 3Amps  
 Insulation Resistance: 1000MΩ Min  
 Contact Resistance: 20mΩ Max  
 Withstanding Voltage: AC 1000V  
 Operation Temperature: -40 ° to +105 °  
 Contact Material: Brass  
 Standard: PBT  
 Insulator Material: Polyester (UL 94V-0)  
 Contact Plating: Gold Flash  
 Max. Processing Temp: 200 ° C for 30-60 seconds  
 (220 ° C for 5 seconds)

## Code Description

- (1) Pin Spacing: 254=2.54mm
- (2) Product Name: FH=Female Header
- (3) No. of Rows: 1=Single Row ; 2=Dual Row
- (4) No. of Pins Per Row: 1~40
- (5) Insulator Material Height: 50=5.0mm; 85=8.5mm
- (6) Connector Type: S=Straight; R=Right Angle; M=SMT
- (7) Connector Material Length: 30=3.0mm; 32=3.2mm
- (8) Insulator Material Width: 50=5.0mm; 55=5.5mm
- (9) Contact Plating: G0=Gold Flash; AU15=Au 1.5u"
- (10) Connector Material Type: U=U Type; Y=Y Type
- (11) Insulator Material Option:  
 A=BK-PBT; B=BK-PA6T; C=BK-PA46; D=KB-LCP; S=Special

深圳市金航标电子有限公司

WWW.BDS666.COM

KH-2.54FH-1X15P-H8.5

0755-83044319

UNLESS OTHERWISE SPECIFIED TOLERANCE  
 X : ±0.3 X° : ±5°  
 X.X : ±0.2 X.X° : ±1°  
 X.XX : ±0.1 X.XX° : ±0.5°

|                                      |    |       |      |             |     |          |
|--------------------------------------|----|-------|------|-------------|-----|----------|
| DRAWING NAME: 2.54FH 1xnPin H8.5 DIP |    |       |      |             | GYS |          |
| SIZE                                 | A4 | SCALE | N: 1 | PROJECT NO. |     |          |
| REV                                  | A  | UNIT  | mm   | PROJECT     |     | PAGE 1/1 |

CHECKED: LI BEI LIN 12/03/07 CHECKED: / / APPROVED: / /

| No. of | DIM. A | DIM. B | No. of | DIM. A | DIM. B | No. of | DIM. A | DIM. B | No. of | DIM. A | DIM. B |
|--------|--------|--------|--------|--------|--------|--------|--------|--------|--------|--------|--------|
| 1      | 0.00   | 2.54   | 11     | 25.40  | 27.94  | 21     | 50.80  | 53.34  | 31     | 76.20  | 78.74  |
| 2      | 2.54   | 5.08   | 12     | 27.94  | 30.48  | 22     | 53.34  | 55.88  | 32     | 78.74  | 81.28  |
| 3      | 5.08   | 7.62   | 13     | 30.48  | 33.02  | 23     | 55.88  | 58.42  | 33     | 81.28  | 83.82  |
| 4      | 7.62   | 10.16  | 14     | 33.02  | 35.56  | 24     | 58.42  | 60.96  | 34     | 83.82  | 86.36  |
| 5      | 10.16  | 12.70  | 15     | 35.56  | 38.10  | 25     | 60.96  | 63.50  | 35     | 86.36  | 88.90  |
| 6      | 12.70  | 15.24  | 16     | 38.10  | 40.64  | 26     | 63.50  | 66.04  | 36     | 88.90  | 91.44  |
| 7      | 15.24  | 17.78  | 17     | 40.64  | 43.18  | 27     | 66.04  | 68.58  | 37     | 91.44  | 93.98  |
| 8      | 17.78  | 20.32  | 18     | 43.18  | 45.72  | 28     | 68.58  | 71.12  | 38     | 93.98  | 96.52  |
| 9      | 20.32  | 22.86  | 19     | 45.72  | 48.26  | 29     | 71.12  | 73.66  | 39     | 96.52  | 99.06  |
| 10     | 22.86  | 25.40  | 20     | 48.26  | 50.80  | 30     | 73.66  | 76.20  | 40     | 99.06  | 101.60 |