

Kinghelm®

REVISIONS					
REV	NUMBER	DESCRIPTION	DWN	CHK	DATE
A		DESIGN			

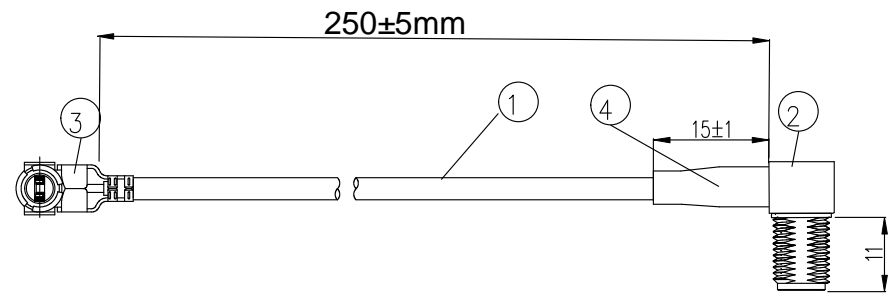

- NOTES:
- ELECTRICAL:
 - VOLTAGE RATING:DCV 100V 10MS
 - CONDUCTANCE RESISTANCE: 3.0 OHM/MAX.
 - INSULATION RESISTANCE: 20M OHM/MIN.
 - THE CABLE SHOULD BE 100% ELECTRICAL TEST
 - IT SHOULD BE NO ANY OPEN/SHORT, MISWIRING AND INTERMITTENT FAILURES.
 - MATERIAL:
 - SEE TABLE
 - ALL COMPONENTS ARE RoHS COMPLIANT.

ITEM NO.	PART NUMBER	DESCRIPTION	QTY.
④	套管	黑色热缩套管, 2*15MM	AS
③	接头	三代IPEX0.81国产端子	1
②	接头	SMA母头母针 弯头, 11牙, 镀金	1
①	同轴线	RF0.81黑色线, OD: 0.81mm	AS

深圳市金航标电子有限公司 www.kinghelm.com.cn
 型号: KH-SMAKW-IPEX3-RG0.81-B250 0755-83044319

ALL DIMENSION ARE IN MM	DRAWN Jamy	DATE 2019 /03 /01	I-PEX to SMA/F L=250MM						
COMPUTER GENERATED IN SOLIDWORKS	ENG.								
DO NOT SCALE THIS DRAWING	MFG.								
PROJECTION	Q.A.								
CUSTOMER P/N:	GENERAL TOLERANCE FOR ANGLES X.X X.XX X.XXX ± 1' ± 0.3 ± 0.25 ± 0.150		<table border="1"> <tr> <td>SIZE</td> <td>Number</td> <td>REV</td> </tr> <tr> <td>B</td> <td></td> <td>A</td> </tr> </table>	SIZE	Number	REV	B		A
SIZE	Number	REV							
B		A							
SCALE: Free		TYPE	SHEET 1 OF 1						