

# Kinghelm®

REVISIONS					
REV	NUMBER	DESCRIPTION	DWN	CHK	DATE
A		DESIGN			

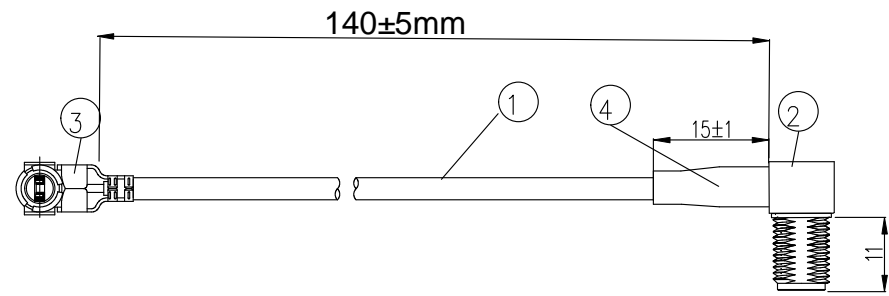

- NOTES:
- ELECTRICAL:
    - VOLTAGE RATING:DCV 100V 10MS
    - CONDUCTANCE RESISTANCE: 3.0 OHM/MAX.
    - INSULATION RESISTANCE: 20M OHM/MIN.
    - THE CABLE SHOULD BE 100% ELECTRICAL TEST
    - IT SHOULD BE NO ANY OPEN/SHORT, MISWIRING AND INTERMITTENT FAILURES.
  - MATERIAL:
    - SEE TABLE
  - ALL COMPONENTS ARE RoHS COMPLIANT.

ITEM NO.	PART NUMBER	DESCRIPTION	QTY.
④	套管	黑色热缩套管, 3.5 *15MM	AS
③	接头	一代IPEX国产端子	1
②	接头	SMA母头母针 弯头, 11牙, 镀金	1
①	同轴线	RF1.78棕色线, OD: 1.8mm	AS

深圳市金航标电子有限公司

www.kinghelm.com.cn

型号: KH-SMAKW-IPEX-RG1.78-140

0755-83044319

ALL DIMENSION ARE IN MM	DRAWN Jamy	DATE 2019 /03 /01
COMPUTER GENERATED IN SOLIDWORKS	ENG.	
DO NOT SCALE THIS DRAWING	MFG.	
	Q.A.	

I-PEX to SMA/F L=140MM

CUSTOMER P/N:

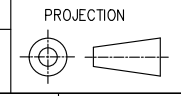

GENERAL TOLERANCE FOR ANGLES		
X.X	X.XX	X.XXX
± 1'	± 0.3 ± 0.25 ± 0.150	

SIZE	Number	REV
B		A
SCALE: Free	TYPE	SHEET 1 OF 1